

**SORTER CONNECTOR UNIT**

**(5946)**

## **SORTER CONNECTOR UNIT (5946)**

<b>Location of Unit . . . . .</b>	<b>3</b>
<b>1. Transport Section (5946) . . . . .</b>	<b>4</b>
<b>2. Vertical Transport Section (5946) . . . . .</b>	<b>6</b>
<b>3. main Board–2nd Sorter (5946) . . . . .</b>	<b>8</b>
<b>4. Safety Switch and Motor         Harnesses (5946) . . . . .</b>	<b>10</b>
<b>5. Sorter Control and Front Door Switch         Harnesses (5946) . . . . .</b>	<b>12</b>
<b>6. Decal and Document (5946) . . . . .</b>	<b>14</b>
<b>Parts Index . . . . .</b>	<b>18</b>

# LOCATION OF UNIT

April 30, '89

## 1. TRANSPORT SECTION

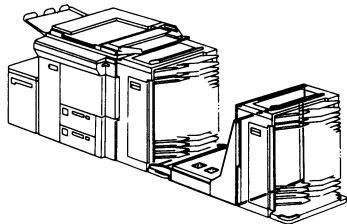

See page 4

## 2. VERTICAL TRANSPORT SECTION

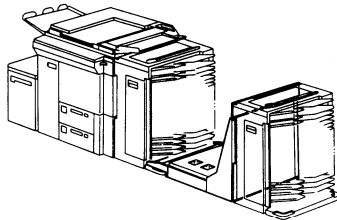

See page 6

# 1. TRANSPORT SECTION (5946)

April 30, '89

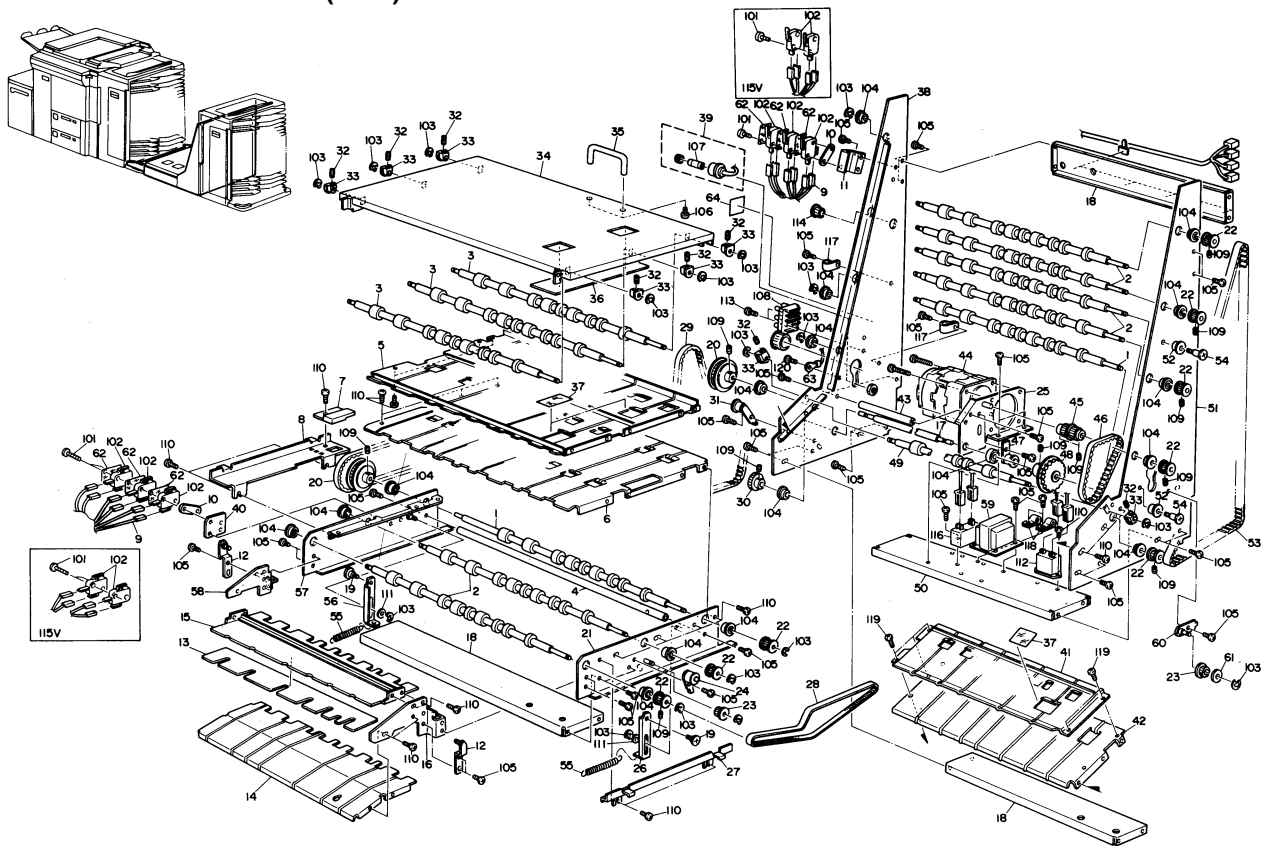

# 1. TRANSPORT SECTION (5946)

April 30, '89

Index No.	Part No.	Description	Q'ty Per Assembly
1	5887 4130	Vertical Drive Roller - A	2
2	5887 4131	Vertical Drive Roller - B	6
3	5887 4132	Vertical Driven Roller	3
4	5887 4120	Stay - Side Plate	1
5	5946 2451	Driven Guide Plate	1
6	5946 2461	Drive Guide Plate	1
7	5946 2475	Cover - Pulley	1
8	5946 2472	Bracket - Rear Side Cover	1
9	5946 5200	Safety Switch Harness	1
10	5056 0509	Nut Plate - Microswitch	2
11	5946 2631	Safety Switch Bracket	1
12	5946 2491	Side Support Plate	2
13	5946 2433	Mylar Seal - Upper Guide Plate	1
14	5946 2441	Lower Guide Plate	1
15	5946 2431	Upper Guide Plate	1
16	5946 2215	Front Rocking Plate	1
17	5946 3761	Drive Shaft	1
18	5946 3177	Stay	3
19	5403 2075	Stepped Screw	2
20	5946 2541	Pulley - 21T	2
21	5946 2210	Front Side Plate - Horizontal Unit	1
22	5887 4190	Pulley - 10T	8
23	5887 4183	Idler Pulley	3
24	5946 2511	Transport Roller Tightener	1
25	5946 3721	Drive Motor Bracket	1
26	5946 2611	Front Side Link	1
27	5946 2471	Bracket - Front Side Cover	1
28	5946 2561	Timing Belt - 198XL	1
29	5946 3781	Timing Belt - 182XL	1
30	5887 2250	Pulley - 17T	1
31	5946 3791	Belt Tightener	1
32	5887 4156	Spring - Driven Roller	8
33	5887 4155	Shaft Guide - Turn Driven	8
34	5946 2481	Driven Side Cover	1
35	5880 1108	Grip	1

Index No.	Part No.	Description	Q'ty Per Assembly
36	5946 2489	Partition Plate - 62x210mm	1
37	5946 2453	Mylar Seak - 0.125x54x55mm	3
38	5946 3320	Rear Side Plate - Vertical Unit	1
39	5946 5110	Fuse Ass'y - 115V	1
39	5946 5120	Fuse Ass'y - 220/240V	1
40	5946 2681	Support Plate-Safety Switch Bracket	1
41	5946 3411	Upper Guide Plate - Driven Roller	1
42	5946 3421	Lower Guide Plate - Driven Roller	1
43	5946 3771	Support Stay - Side Plate	1
44	5887 5400	Drive Motor - AC35W/100V (115V)	1
44	5887 5420	Drive Motor - AC35W/220V (220/240V)	1
45	5887 2120	Pulley - 15T/18T	1
46	5946 3741	Timing Belt - 150XL	1
47	5946 3731	Motor Tightener	1
48	5887 2136	Pulley - 40T	1
49	5887 4133	Exit Roller	1
50	5946 3331	Drive Motor Stay	1
51	5946 3310	Front Side Plate - Vertical Unit	1
52	5887 4185	Idler Roller	2
53	5946 3625	Timing Belt - 460XL	1
54	5887 4195	Stopper Screw	2
55	5946 2651	Spring - Transport Cover	2
56	5946 2621	Rear Side Link	1
57	5946 2220	Rear Side Plate - Horizontal Unit	1
58	5946 2225	Rear Rocking Plate	1
59	5946 5300	Transformer	1
60	5946 3351	Tightener Bracket	1
61	5946 3355	Washer - Tightener	1
62	5887 4520	Insulating Sheet - 220V	6
63	5937 5782	Grounding Wire	1
64	5403 4335	Decal - Terminal - 115V	1
64	5447 4980	Decal - Terminal - 220/240V	1



Index No.	Part No.	Description	Q'ty Per Assembly
101	0313 0250W	Philips Pan Head Screw - M3x25 (115V)	
101	0313 0350W	Philips Pan Head Screw - M3x35 (220V)	
102	1204 1151	Microswitch	
102	1204 0795	Microswitch - 220/240V	
103	0720 0040E	Retaining Ring - M4	
104	0741 3906	Busing - 6mm	
105	0434 0080W	Tapping Screw - M4x8	
106	0315 0080W	Philips Pan Head Screw - M5x8	
107	1107 0413	Fuse - 3A (115V)	
107	1107 0265	Fuse - 3A (220/240V)	
108	1101 0359	Terminal - 3P	
109	0574 0050E	Hexagon Headless Set Screw - M4x5	
110	0313 0060W	Philips Pan Head Screw - M3x6	
111	0807 4053	Spacer - 6.2x9.5x0.1mm	
112	1208 1230	Relay - G2R-11123T-V-US	
113	0313 0150W	Philips Pan Head Screw - M3x15	
114	1106 0212	Bushing - 15øF	
115	0801 1185	Philips Truss Head Screw - M4x8	
116	1606 0994	Capacitor - 12MF (115V)	
116	1606 1382	Capacitor - 12µF (220/240V)	
117	1105 0005	Nylon Clip - 3N	
118	1105 0009	Nylon Clip - 5N	
119	0951 3006W	Philips Screw With Flat Washer - M3x6	
120	0314 0080M	Philips Pan Head Screw - M4x8	



Index No.	Part No.	Description	Q'ty Per Assembly



## 2. VERTICAL TRANSPORT SECTION (5946)

April 30, '89

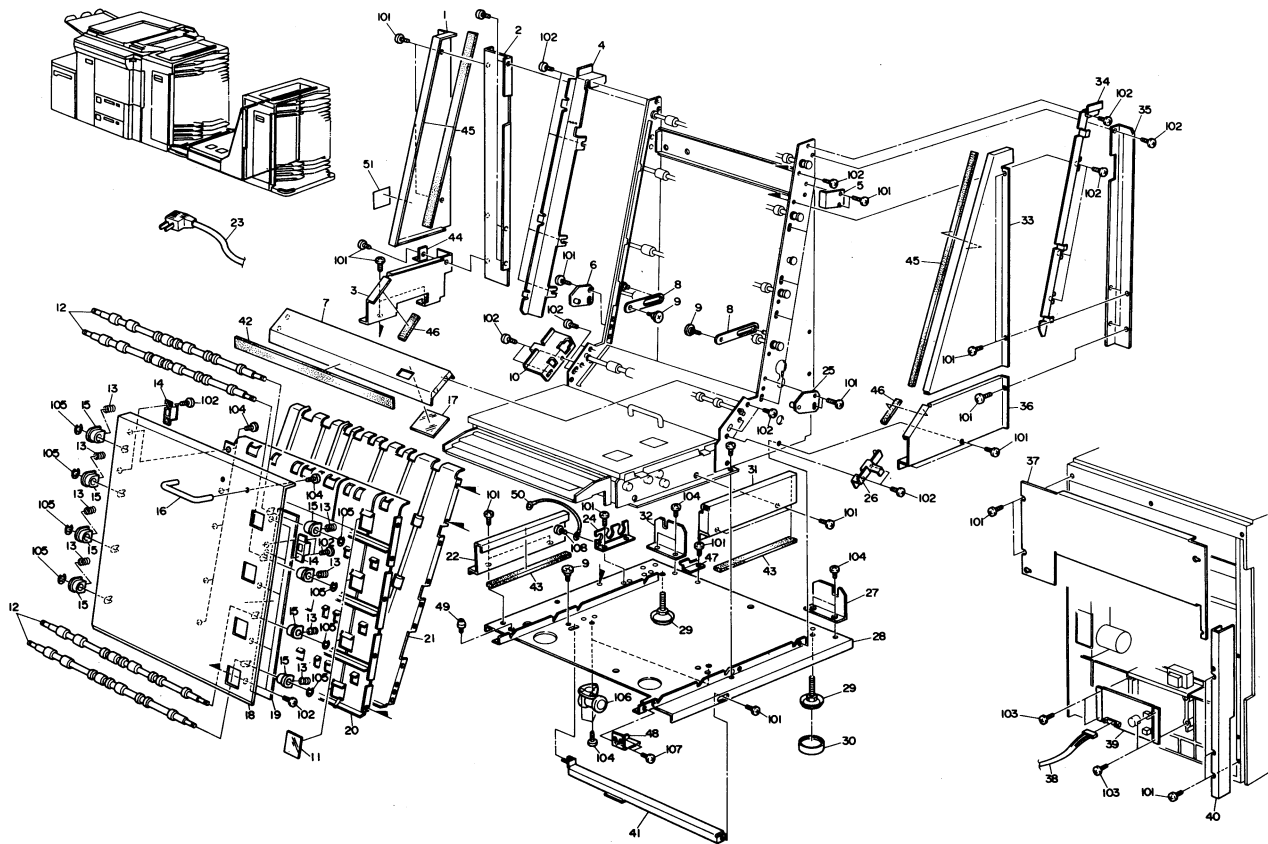

## 2. VERTICAL TRANSPORT SECTION (5946)

April 30, '89

Index No.	Part No.	Description	Q'ty Per Assembly
1	5946 4461	Rear Upper Cover - Vertical	1
2	5946 3655	Angle - Vertical Rear Cover	1
3	5946 4451	Rear Bottom Cover - Vertical	1
4	5946 3526	Rear Cover Bracket	1
5	5946 2641	Magnet Catch Bracket	1
6	5946 3565	Rear Support Plate-Vertical	1
7	5946 3611	Fixing Cover	1
8	5946 3631	Link - Vertical Unit	2
9	5403 2075	Stepped Screw	3
10	5946 3516	Bracket - Rear Fix Cover	1
11	5946 2453	Mylar Seal - 0.125x54x55mm	4
12	5887 4132	Vertical Driven Roller	4
13	5887 4156	Spring - Driven Roller	8
14	5054 0536	Magnet Catch Ass'y	2
15	5887 4155	Shaft Guide - Turn Driven	8
16	5880 1108	Grip	1
17	5946 3621	Partition Plate - 62x62mm	1
18	5946 3531	Vertical Driven Cover	1
19	5946 3541	Partition Plate - 62x425mm	1
20	5946 3551	Driven Guide Plate - Vertical Unit	1
21	5946 3431	Guide Plate - Vertical Drive	1
22	5946 4421	Horizontal Rear Cover	1
23	5946 5230	Power Supply Cord - 115V	1
23	5946 5231	Power Supply Cord - 220/240V	1
24	5946 1151	Harness Bracket	1
25	5946 3561	Front Support Plate - Vertical	1
26	5946 3511	Bracket - Front Fix Cover	1
27	5946 1141	Front Positioning Angle	1
28	5946 1101	Bottom Plate	1
29	5424 1064	Screw Stand	2
30	5446 1086	Leveling Foot Guide	2
31	5946 4411	Horizontal Front Cover	1
32	5946 1146	Rear Positioning Angle	1
33	5946 4441	Front Upper Cover - Vertical	1
34	5946 3521	Front Cover Bracket	1

Index No.	Part No.	Description	Q'ty Per Assembly
35	5946 3651	Angle - Vertical Front Cover	1
36	5946 4431	Front Bottom Cover - Vertical	1
37	5946 4481	Shielding Plate	1
38	5946 5210	Sorter Control Harness	1
39	5946 5601	Main Board - 2nd Sorter	1
40	5946 4471	Front Shielding Plate	1
41	5946 1111	Base Fixing Bracket	1
42	5887 1202	Magnet - Upper Cover	1
43	5946 4521	Pad - 5x20x240mm	2
44	5946 4511	Stopper Clamp Angle	1
45	5946 4541	Pad - 5x20x480mm	2
46	5946 4531	Pad - 5x20x90mm	2
47	5946 3641	Fixing Plate - Side Plate	1
48	5946 6111	Front Fixing Bracket	1
49	5946 6121	Docking Pin	1
50	5937 5780	Grounding Wire	1
51	5446 8906	Caution Decal	1
101	0434 0080W	Tapping Screw - M4x8	
102	0313 0060W	Philips Pan Head Screw - M3x6	
103	0314 0060W	Philips Pan Head Screw - M4x6	
104	0315 0080W	Philips Pan Head Screw - M5x8	
105	0720 0040E	Retaining Ring - M4	
106	0805 5003	Caster	
107	0314 0080W	Philips Pan Head Screw - M4x8	
108	0801 1185	Philips Truss Head Screw - M4x8	

### 3. MAIN BOARD – 2ND SORTER (5946)

April 30, '89

#### CAPACITOR

SYMBOL NO.	INDEX NO.
C131	122
C132	124
C133	124
C134	121
C201	122
C202	122
C203	123
C204	123
C205	123
C206	123

SYMBOL NO.	INDEX NO.
C207	123
C208	123
C209	123
C210	123
C211	123
C212	123
C213	123
C214	123
C215	123
C216	123

SYMBOL NO.	INDEX NO.
C217	123

#### CONNECTOR

SYMBOL NO.	INDEX NO.
CN201	105
CN202	104
CN204	102
CN205	103
CN212	106
CN213	101

#### DIODE

SYMBOL NO.	INDEX NO.
D102	112
D201	112

#### FUSE HOLDER

SYMBOL NO.	INDEX NO.
FH	107

#### FUSE

SYMBOL NO.	INDEX NO.
FU102	108

#### RC ARRAY

SYMBOL NO.	INDEX NO.
HB201	120
HB202	120

#### IC

SYMBOL NO.	INDEX NO.
IC117	1
IC201	117
IC202	110
IC203	116
IC204	117
IC205	110
IC206	117
IC207	110
IC208	115
IC209	116

#### IC

SYMBOL NO.	INDEX NO.
IC210	110

#### LED

SYMBOL NO.	INDEX NO.
LED113	114

#### TRANSISTOR

SYMBOL NO.	INDEX NO.
Q201	111

#### RESISTOR

SYMBOL NO.	INDEX NO.
R114	126
R115	127
R201	125

#### RESISTOR ARRAY

SYMBOL NO.	INDEX NO.
RAY201	119
RAY202	119
RAY203	119
RAY204	119
RAY205	119
RAY206	119
RAY207	119
RAY208	118

#### SSR

SYMBOL NO.	INDEX NO.
SSR201	109

#### RECTIFIER

SYMBOL NO.	INDEX NO.
ST102	113



### 3. MAIN BOARD – 2ND SORTER (5946)

April 30, '89

Index No.	Part No.	Description	Q'ty Per Assembly
1	5937 5604	IC - SI-3242P	
*	5946 5601	Main Board - 2nd Sorter	

Index No.	Part No.	Description	Q'ty Per Assembly
101	1102 0911	Connector - 8P	
102	1102 0995	Connector - 2P	
103	1102 1039	Connector - 4P	
104	1102 2566	Connector - 2P	
105	1102 2702	Connector - 24P	
106	1103 0755	Connector - 50P	
107	1104 0307	Fuse Clip	
108	1107 0413	Fuse - 3A (220V)	
109	1208 1047	Solid State Relay - 240V 3A	
110	1401 0192	IC - $\mu$ PA2003C	
111	1401 0234	Transistor - 2SD686	
112	1401 0832	Diode - DSA1A1	
113	1402 0291	Rectifier - S2VB10	
114	1403 0308	LED - TLR-102A	
115	1407 0711	IC - 74LSI51N	
116	1407 1607	IC - TD62603P	
117	1407 1698	IC - TD62801P	
118	1601 7372	Resistor Array - 2.2KOHM	
119	1601 7374	Resistor Array - 4.7KOHM	
120	1602 0911	RC Array - RC082	
121	1604 1130	Capacitor - 2200 $\mu$ F 50V	
122	1604 1254	Capacitor - 47 $\mu$ F 50V	
123	1606 0533	Capacitor - 0.01 $\mu$ F 50V	
124	1606 0658	Capacitor - 0.1 $\mu$ F 50V	
125	1611 4102	Resistor - 1KOHM 1/4T $\pm$ 5%	
126	1611 4103	Resistor - 10KOHM 1/4T $\pm$ 5%	
127	1611 4223	Resistor - 22KOHM 1/4T $\pm$ 5%	

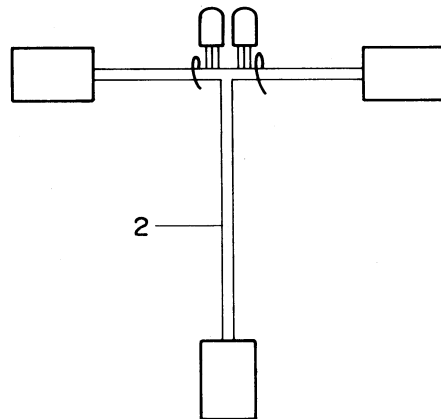
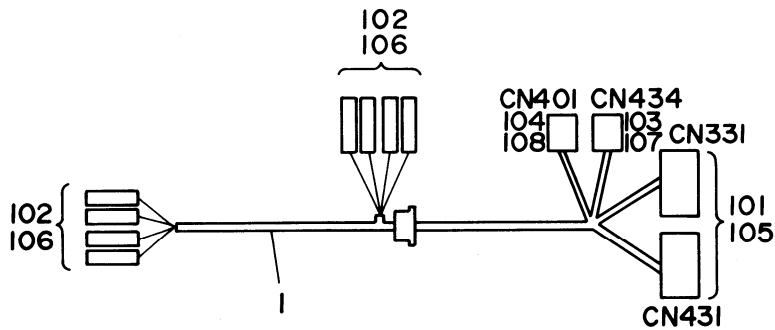

#### 4. SAFETY SWITCH AND MOTOR HARNESSSES (5946)

April 30, '89

Index No.	Part No.	Description	Q'ty Per Assembly
1	5946 5200	Safety Switch Harness	1
2	5946 5220	Motor Harness	1

Index No.	Part No.	Description	Q'ty Per Assembly
101	1100 1159	Socket - Mate-N-Lock	
102	1100 1169	Fastening Receptacle	
103	1100 1238	Pin - Mate-N-Lock	
104	1100 1240	Socket - Mate-N-Lock	
105	1102 1309	Connector - 8P	
106	1102 1408	Connector - 2P	
107	1102 1507	Connector - 2P	
108	1102 1515	Connector - 2P	

# 5. SORTER CONTROL AND FRONT DOOR SWITCH HARNESSES (5946)

April 30, '89

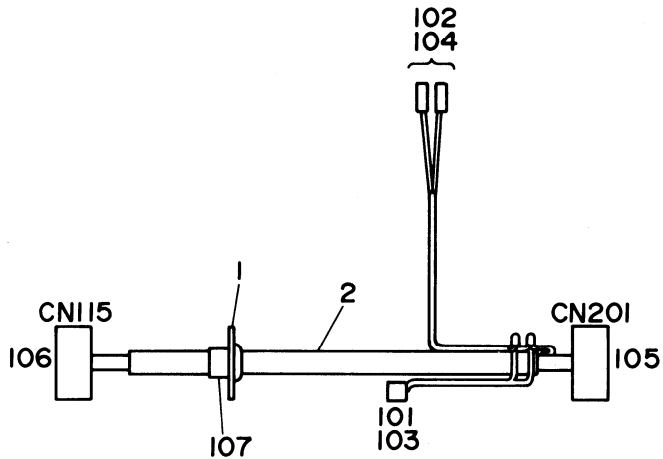

(220/240V Only)

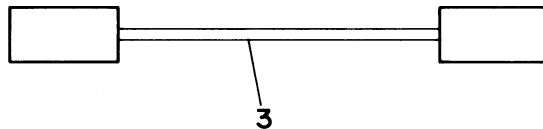

## 5. SORTER CONTROL AND FRONT DOOR SWITCH HARNESSSES (5946)

April 30, '89

Index No.	Part No.	Description	Q'ty Per Assembly
1	5946 1152	Harness Fixing Plate	1
2	5946 5210	Sorter Control Harness	1
3	5887 5734	Front Door Switch Harness - 220/240V	1

Index No.	Part No.	Description	Q'ty Per Assembly
101	1100 1159	Socket - Mate-N-Lock	
102	1100 1169	Fastening Receptacle	
103	1102 1396	Connector - 2P	
104	1102 1408	Connector - 1P	
105	1102 2703	Cable Connector - 2-172866-4 - 24P	
106	1102 2704	Cable Connector - 2-172866-0 - 20P	
107	1106 0101	Cord Stopper	

1

NOTE: When using more than 20 bins, inspect the sorter connector and the second sorter.

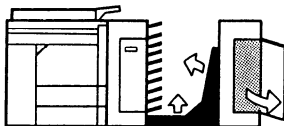

Sorter Connector/Second Sorter

2

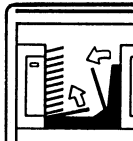

Open the covers of the sorter connector and remove the misfed paper.

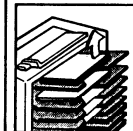

Remove the extra sheets from the proof tray of the second sorter.

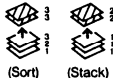

(Sort) (Stack)

3

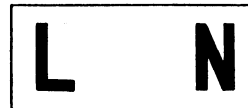

4



5

Français/Frans語

NOTE: Quand vous utilisez plus de 20 cases, contrôler le connecteur trieuse et la seconde trieuse.

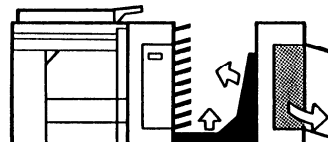

Connecteur trieuse/Seconde trieuse.

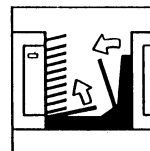

Ouvrir les carters du connecteur trieuse et retirer le bourrage papier

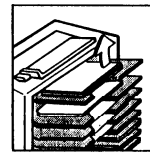

Retirer les feuilles supplémentaires du plateau copie de la seconde trieuse.

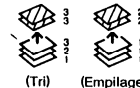

(Tri) (Empilage)

## 6. DECAL AND DOCUMENT (5946)

April 30, '89

Index No.	Part No.	Description	Q'ty Per Assembly
1	5946 6211	Decal - English	1
2	5946 6221	Decal - English	1
3	5403 4335	Decal - Terminal - 115V	1
4	5447 4980	Decal - Terminal - 220/240V	1
5	5946 6225	Decal - Multilanguage	1

Index No.	Part No.	Description	Q'ty Per Assembly
-----------	----------	-------------	-------------------

# **PARTS INDEX**



Parts No.	Description	Page and Index No.
5946 1101	Bottom Plate	7-28
5946 1111	Base Fixing Bracket	7-41
5946 1141	Front Positioning Angle	7-27
5946 1146	Rear Positioning Angle	7-32
5946 1151	Harness Bracket	7-24
5946 1152	Harness Fixing Plate	13-1
5946 2210	Front Side Plate - Horizontal Unit	5-21
5946 2215	Front Rocking Plate	5-16
5946 2220	Rear Side Plate - Horizontal Unit	5-57
5946 2225	Rear Rocking Plate	5-58
5946 2431	Upper Guide Plate	5-15
5946 2433	Mylar Seal - Upper Guide Plate	5-13
5946 2441	Lower Guide Plate	5-14
5946 2451	Driven Guide Plate	5-5
5946 2453	Mylar Seak - 0.125x54x55mm	5-37
5946 2453	Mylar Seal - 0.125x54x55mm	7-11
5946 2461	Drive Guide Plate	5-6
5946 2471	Bracket - Front Side Cover	5-27
5946 2472	Bracket - Rear Side Cover	5-8
5946 2475	Cover - Pulley	5-7
5946 2481	Driven Side Cover	5-34
5946 2489	Partition Plate - 62x210mm	5-36
5946 2491	Side Support Plate	5-12
5946 2511	Transport Roller Tightener	5-24
5946 2541	Pulley - 21T	5-20
5946 2561	Timing Belt - 198XL	5-28
5946 2611	Front Side Link	5-26
5946 2621	Rear Side Link	5-56
5946 2631	Safety Switch Bracket	5-11
5946 2641	Magnet Catch Bracket	7-5
5946 2651	Spring - Transport Cover	5-55
5946 2681	Support Plate-Safety Switch Bracket	5-40
5946 3177	Stay	5-18
5946 3310	Front Side Plate - Vertical Unit	5-51
5946 3320	Rear Side Plate - Vertical Unit	5-38

Parts No.	Description	Page and Index No.
5946 3331	Drive Motor Stay	5-50
5946 3351	Tightener Bracket	5-60
5946 3355	Washer - Tightener	5-61
5946 3411	Upper Guide Plate - Driven Roller	5-41
5946 3421	Lower Guide Plate - Driven Roller	5-42
5946 3431	Guide Plate - Vertical Drive	7-21
5946 3511	Bracket - Front Fix Cover	7-26
5946 3516	Bracket - Rear Fix Cover	7-10
5946 3521	Front Cover Bracket	7-34
5946 3526	Rear Cover Bracket	7-4
5946 3531	Vertical Driven Cover	7-18
5946 3541	Partition Plate - 62x425mm	7-19
5946 3551	Driven Guide Plate - Vertical Unit	7-20
5946 3561	Front Support Plate - Vertical	7-25
5946 3565	Rear Support Plate-Vertical	7-6
5946 3611	Fixing Cover	7-7
5946 3621	Partition Plate - 62x62mm	7-17
5946 3625	Timing Belt - 460XL	5-53
5946 3631	Link - Vertical Unit	7-8
5946 3641	Fixing Plate - Side Plate	7-47
5946 3651	Angle - Vertical Front Cover	7-35
5946 3655	Angle - Vertical Rear Cover	7-2
5946 3721	Drive Motor Bracket	5-25
5946 3731	Motor Tightener	5-47
5946 3741	Timing Belt - 150XL	5-46
5946 3761	Drive Shaft	5-17
5946 3771	Support Stay - Side Plate	5-43
5946 3781	Timing Belt - 182XL	5-29
5946 3791	Belt Tightener	5-31
5946 4411	Horizontal Front Cover	7-31
5946 4421	Horizontal Rear Cover	7-22
5946 4431	Front Bottom Cover - Vertical	7-36
5946 4441	Front Upper Cover - Vertical	7-33
5946 4451	Rear Bottom Cover - Vertical	7-3
5946 4461	Rear Upper Cover - Vertical	7-1

Parts No.	Description	Page and Index No.
5946 4471	Front Shielding Plate	7-40
5946 4481	Shielding Plate	7-37
5946 4511	Stopper Clamp Angle	7-44
5946 4521	Pad - 5x20x240mm	7-43
5946 4531	Pad - 5x20x90mm	7-46
5946 4541	Pad - 5x20x480mm	7-45
5946 5110	Fuse Ass'y - 115V	5-39
5946 5120	Fuse Ass'y - 220/240V	5-39
5946 5200	Safety Switch Harness	11-1
5946 5200	Safety Switch Harness	5-9
5946 5210	Sorter Control Harness	13-2
5946 5210	Sorter Control Harness	7-38
5946 5220	Motor Harness	11-2
5946 5230	Power Supply Cord - 115V	7-23
5946 5231	Power Supply Cord - 220/240V	7-23
5946 5300	Transformer	5-59
5946 5601	Main Board - 2nd Sorter	7-39
5946 5601	Main Board - 2nd Sorter	9-*
5946 6111	Front Fixing Bracket	7-48
5946 6121	Docking Pin	7-49
5946 6211	Decal - English	15-1
5946 6221	Decal - English	15-2
5946 6225	Decal - Multilanguage	15-5

Parts No.	Description	Page and Index No.
5054 0536	Magnet Catch Ass'y	7-14
5056 0509	Nut Plate - Microswitch	5-10
5403 2075	Stepped Screw	5-19
5403 2075	Stepped Screw	7-9
5403 4335	Decal - Terminal - 115V	15-3
5403 4335	Decal - Terminal - 115V	5-64
5424 1064	Screw Stand	7-29
5446 1086	Leveling Foot Guide	7-30
5446 8906	Caution Decal	7-51
5447 4980	Decal - Terminal - 220/240V	15-4
5447 4980	Decal - Terminal - 220/240V	5-64
5880 1108	Grip	5-35
5880 1108	Grip	7-16
5887 1202	Magnet - Upper Cover	7-42
5887 2120	Pulley - 15T/18T	5-45
5887 2136	Pulley - 40T	5-48
5887 2250	Pulley - 17T	5-30
5887 4120	Stay - Side Plate	5-4
5887 4130	Vertical Drive Roller - A	5-1
5887 4131	Vertical Drive Roller - B	5-2
5887 4132	Vertical Driven Roller	5-3
5887 4132	Vertical Driven Roller	7-12
5887 4133	Exit Roller	5-49
5887 4155	Shaft Guide - Turn Driven	5-33
5887 4155	Shaft Guide - Turn Driven	7-15
5887 4156	Spring - Driven Roller	5-32
5887 4156	Spring - Driven Roller	7-13
5887 4183	Idler Pulley	5-23
5887 4185	Idler Roller	5-52
5887 4190	Pulley - 10T	5-22
5887 4195	Stopper Screw	5-54
5887 4520	Insulating Sheet - 220V	5-62
5887 5400	Drive Motor - AC35W/100V (115V)	5-44
5887 5420	Drive Motor - AC35W/220V (220/240V)	5-44
5887 5734	Front Door Switch Harness - 220/240V	13-3

Parts No.	Description	Page and Index No.
5937 5604	IC - SI-3242P	9-1
5937 5780	Grounding Wire	7-50
5937 5782	Grounding Wire	5-63

Parts No.	Description	Page and Index No.
0313 0060W	Philips Pan Head Screw - M3x6	5-110
0313 0060W	Philips Pan Head Screw - M3x6	7-102
0313 0150W	Philips Pan Head Screw - M3x15	5-113
0313 0250W	Philips Pan Head Screw - M3x25 (115V)	5-101
0313 0350W	Philips Pan Head Screw - M3x35 (220V)	5-101
0314 0060W	Philips Pan Head Screw - M4x6	7-103
0314 0080M	Philips Pan Head Screw - M4x8	5-120
0314 0080W	Philips Pan Head Screw - M4x8	7-107
0315 0080W	Philips Pan Head Screw - M5x8	5-106
0315 0080W	Philips Pan Head Screw - M5x8	7-104
0434 0080W	Tapping Screw - M4x8	5-105
0434 0080W	Tapping Screw - M4x8	7-101
0574 0050E	Hexagon Headless Set Screw - M4x5	5-109
0720 0040E	Retaining Ring - M4	5-103
0720 0040E	Retaining Ring - M4	7-105
0741 3906	Busing - 6mm	5-104
0801 1185	Philips Truss Head Screw - M4x8	5-115
0801 1185	Philips Truss Head Screw - M4x8	7-108
0805 5003	Caster	7-106
0807 4053	Spacer - 6.2x9.5x0.1mm	5-111
0951 3006W	Philips Screw With Flat Washer - M3x6	5-119
1100 1159	Socket - Mate-N-Lock	11-101
1100 1159	Socket - Mate-N-Lock	13-101
1100 1169	Fastening Receptacle	11-102
1100 1169	Fastening Receptacle	13-102
1100 1238	Pin - Mate-N-Lock	11-103
1100 1240	Socket - Mate-N-Lock	11-104
1101 0359	Terminal - 3P	5-108
1102 0911	Connector - 8P	9-101
1102 0995	Connector - 2P	9-102
1102 1039	Connector - 4P	9-103
1102 1309	Connector - 8P	11-105
1102 1396	Connector - 2P	13-103
1102 1408	Connector - 2P	11-106
1102 1408	Connector - 1P	13-104

Parts No.	Description	Page and Index No.
1102 1507	Connector - 2P	11-107
1102 1515	Connector - 2P	11-108
1102 2566	Connector - 2P	9-104
1102 2702	Connector - 24P	9-105
1102 2703	Cable Connector - 2-172866-4 - 24P	13-105
1102 2704	Cable Connector - 2-172866-0 - 20P	13-106
1103 0755	Connector - 50P	9-106
1104 0307	Fuse Clip	9-107
1105 0005	Nylon Clip - 3N	5-117
1105 0009	Nylon Clip - 5N	5-118
1106 0101	Cord Stopper	13-107
1106 0212	Bushing - 15øF	5-114
1107 0265	Fuse - 3A (220/240V)	5-107
1107 0413	Fuse - 3A (115V)	5-107
1107 0413	Fuse - 3A (220V)	9-108
1204 0795	Microswitch - 220/240V	5-102
1204 1151	Microswitch	5-102
1208 1047	Solid State Relay - 240V 3A	9-109
1208 1230	Relay - G2R-11123T-V-US	5-112
1401 0192	IC - µPA2003C	9-110
1401 0234	Transistor - 2SD686	9-111
1401 0832	Diode - DSA1A1	9-112
1402 0291	Rectifier - S2VB10	9-113
1403 0308	LED - TLR-102A	9-114
1407 0711	IC - 74LS151N	9-115
1407 1607	IC - TD62603P	9-116
1407 1698	IC - TD62801P	9-117
1601 7372	Resistor Array - 2.2KOHM	9-118
1601 7374	Resistor Array - 4.7KOHM	9-119
1602 0911	RC Array - RC082	9-120
1604 1130	Capacitor - 2200µF 50V	9-121
1604 1254	Capacitor - 47µF 50V	9-122
1606 0533	Capacitor - 0.01µF 50V	9-123
1606 0658	Capacitor - 0.1µF 50V	9-124
1606 0994	Capacitor - 12MF (115V)	5-116

Parts No.	Description	Page and Index No.
1606 1382	Capacitor - 12µF (220/240V)	5-116
1611 4102	Resistor - 1KOHM 1/4T ±5%	9-125
1611 4103	Resistor - 10KOHM 1/4T ±5%	9-126
1611 4223	Resistor - 22KOHM 1/4T ±5%	9-127